

LUXBEAT

LUXBEAT

LINEAR LIGHT



LAST UPDATE: 04-09-2024



LuxBeat and LuxBeat XL are a range of miniature sized linear accent luminaires with flexible and fixed application. The patented optical system emits homogenous light regardless of the viewing direction. LuxBeat is the designer's choice for unconstrained creative light installations. High contrasting illumination of building elements is easily possible with the tiny luminaire dimensions and state of the art LED performance. The luminaire is top bendable and can be shortened on-site. The use of optional stainless steel mounting clips eliminates the time-consuming pretreatment of the installation surface. LuxBeat XL offers a robust aluminum housing that contains a wiring channel for the electrical connection. Bottom mounted in and out connector's assure shadow free easy installation. LuxBeat XL is available as fixed and tiltable surface mount luminaire, recessed wall and ceiling light, pendant light and inground uplighter. Shorter luminaire lengths are available upon request. LuxBeat XL RGBW requires the use of a 4 channel CV RGBW controller, contact the Unilamp sales team for details.

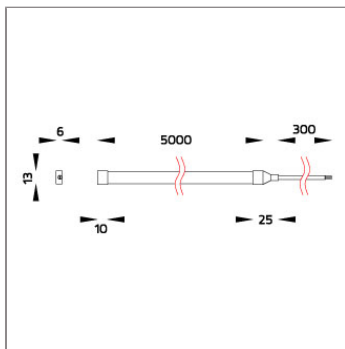

Technical Data



Ordering Code :	8101-0-2-467-00
Lamp :	LED
Beam :	120°
CCT :	3000 K
CRI :	CRI >80
SDCM :	SDCM = 3
Luminaire Lumen :	680 lm/M
Luminaire Wattage :	7 W/M
Efficacy :	97 lm/W/M
Ambient Temperature :	50°C
Lumen Maintenance	L70B10 >50,000 h
Controller :	Remote
Input Voltage :	24Vdc
Net Weight :	- kg.

Ordering code guide

XXXX-X-X-XXX-XX

B
D

A
C
E

- A Product Code
- B Reflector
- C Electrical Component
- D Lamp
- E Color



Icon definition

*Due to the constancy of product development, we reserve the right to alter all specification without prior notice.

Unilamp Co., Ltd.
 461 Ramintra Road, Kannayao, Bangkok 10230 Thailand
 Tel : +66(0)2 943 2420-1, +66(0)2 946 4170-1
 Fax : +66(0)2 943 2419
 online@unilamp.co.th
 www.unilamp.co.th

LUXBEAT

LUXBEAT

LINEAR LIGHT



LAST UPDATE: 04-09-2024

Specification

IEC Standard	IEC 60598-1 General Requirement IEC 60598-2-1 Fixed Luminaires
Protection	IP67 Class III
Luminaires Body Housing	High quality silicone extrusion housing.
Led	High efficiency LED module utilized chips from world renowned manufacturer. Assembled on FPC.
Driver	Driver is not included and has to be ordered separately.
Internal Wire	Tinned copper conductor with silicone insulated internal wire. IMQ approved. Working temperature -40°C to +180°C.
Pre-Wire Cable	Pre-wired cable 2x0.5sqmm, L=300mm
Caution	Installation, dismantling and repairs must be carried out by qualified electrician. Maximum continuous installation length for 1 driver is 5m. Custom length is available [prepared by the factory].

Light Distribution

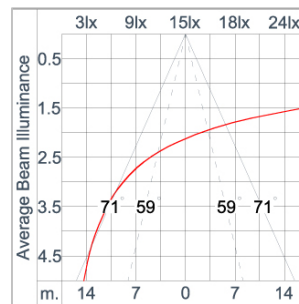
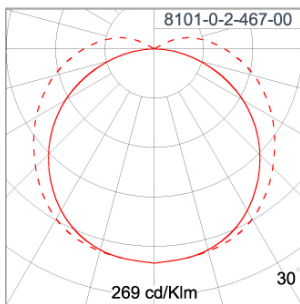

*Due to the constancy of product development,
we reserve the right to alter all specification
without prior notice.

Unilamp Co., Ltd.
461 Ramintra Road, Kannayao, Bangkok 10230 Thailand
Tel : +66[0]2 943 2420-1, +66[0]2 946 4170-1
Fax : +66[0]2 943 2419
online@unilamp.co.th
www.unilamp.co.th

LUXBEAT

LUXBEAT

LINEAR LIGHT



LAST UPDATE: 04-09-2024

Accessories



Ordering Code:
AUN-DRG-0011-00
LED constant voltage
driver, 24VDC, 150W



Ordering Code:
AUN-CAB-0006-00
Feed in cable, L= 300, with
end cap and front cap

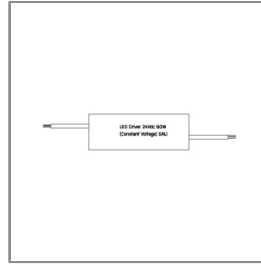

Ordering Code:
AUN-DRG-0022-00
LED constant voltage
driver, 24VDC, 60W, DALI

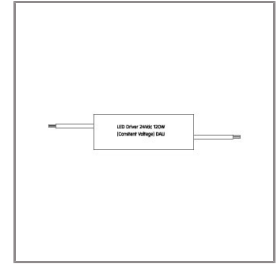

Ordering Code:
AUN-DRG-0023-00
LED constant voltage
driver, 24VDC, 120W, DALI



Ordering Code:
AUN-CON-0024-00
IP68 Connector, cable
diameter 4.8-6mm,
gel-filled

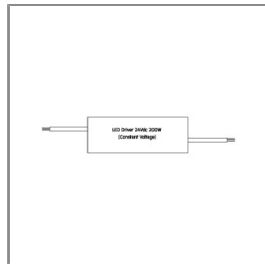

Ordering Code:
AUN-DRG-0024-00
LED constant voltage
driver, 24VDC, 200W

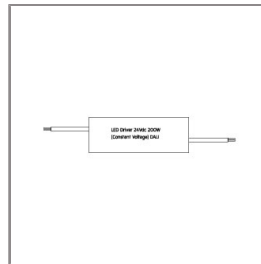

Ordering Code:
AUN-DRG-0025-00
LED constant voltage
driver, 24VDC, 200W, DALI

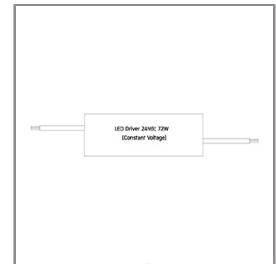

Ordering Code:
AUN-DRG-0027-00
LED constant voltage
driver, 24VDC, 72W

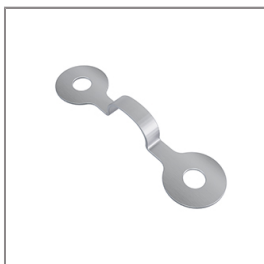

Ordering Code:
AUN-BRK-0009-00
Mounting clip, set of 20pcs

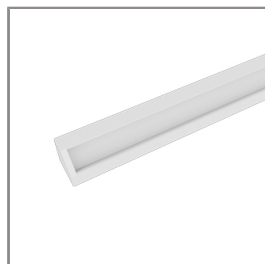

Ordering Code:
AUN-MOT-0061-00
Surface mount profile, L=
1000mm, for corners

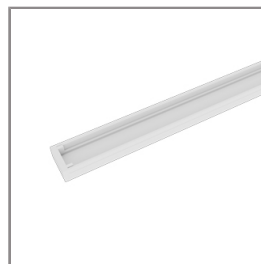

Ordering Code:
AUN-MOT-0062-00
Surface mount profile, L=
1000mm, for flat

*Due to the constancy of product development,
we reserve the right to alter all specification
without prior notice.

Unilamp Co., Ltd.
461 Ramintra Road, Kannayao, Bangkok 10230 Thailand
Tel : +66[0]2 943 2420-1, +66[0]2 946 4170-1
Fax : +66[0]2 943 2419
online@unilamp.co.th
www.unilamp.co.th